

DONOVAN DISMISSAL UPDATE

For the Safety of Our Students



Hello Donovan Families:

We have seen an increase in people refusing to follow the traffic pattern. The Arrival and Dismissal process is designed to allow ALL children to safely enter and exit the building. Please make sure to read all of the information below and FOLLOW THE PROCEDURES TO ENSURE ALL STUDENTS ARE SAFE. If you are sending someone to pick up your child, it is YOUR responsibility to tell them the traffic rules.

Thank you, Principal Gannon
Assistant Principal Sleczkowski

AM / Arrival Procedures:

(Please see the map below on the next page).

- In the morning, form 1 line of traffic on Side B, stay in your car.
- DO NOT drive in the fire lane / Side A on the Map.
- Pull ALL THE WAY FORWARD before stopping to let your student out.
- To ensure all students safety: At NO TIME is ANYONE allowed in the fire lane.
- DO NOT let your child out in the upper parking lot area, wait until you pull into side B of the exiting driveway.
- NO car is allowed to enter the back / playground parking area after 8AM. This is for the safety of children.
- In the morning supervised recess begins at 8:15am (Staff is not available prior to 8:15am; students who arrive prior to 8:15 are not supervised and cannot be permitted in the school building)

PM / Dismissal Procedures:

(Please see the map below on the next page).

- In the afternoon, STAY in your car & form 1 line of traffic on Side A – PULL ALL THE WAY FORWARD to the hydrant.
- DO NOT BLOCK the handicap parking
- DO NOT STOP OR PARK IN THE END OF THE DRIVEWAY – see the area marked on the map.
- When the cars in front of you move pull ALL THE WAY forward.
- Side B is a travel lane. DO NOT STOP on side B because it is a travel lane. NO CHILD WILL BE ALLOWED TO GET IN A CAR THAT IS STOPPED IN THE TRAVEL LANE – you will be told to go around again and follow the traffic pattern.

Students Remaining after 3:30

- Beginning at 3:30PM phone calls will be made to parents. Phone calls will be documented on the Late Pick Log; and students who are consistently picked up late will be required to meet with the school principal, or designee and further action may take place.

Dismissal Map:

Playground /

Staff Parking

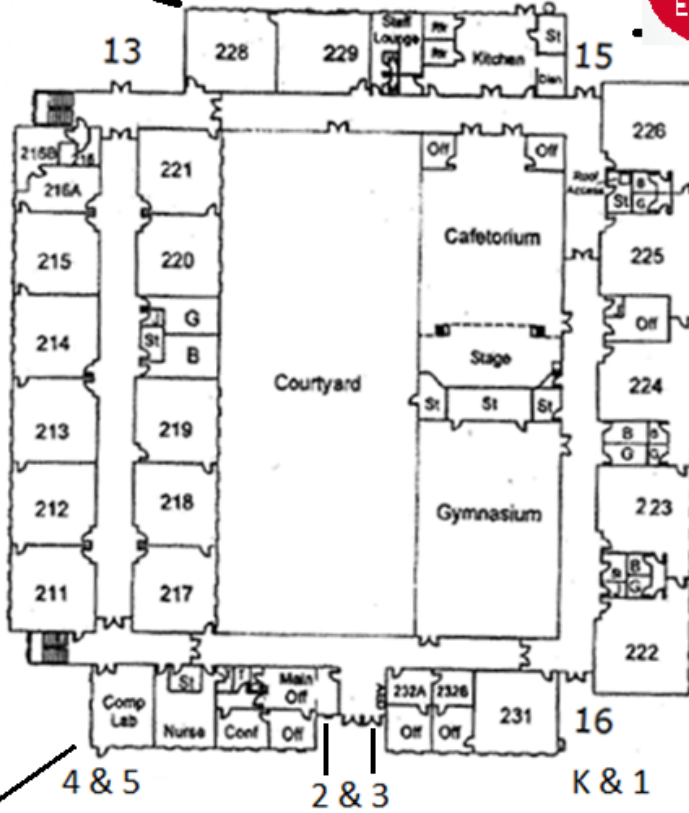

**EMERGENCY
AND
AUTHORIZED
VEHICLES
ONLY**

R
E
E
D

S
T
R
E
E
T

2
0

M
P
H

No Parking

Parking

Handicap parking

Side A: Fire Lane

Side B: Travel lane

Please Read the explanation of AM & PM traffic attached

No Parking or stopping in this area on either side of the road at anytime.

**EXIT ONLY
DO NOT ENTER**



ENTER
←